



Series 1450 Sliding Replica

4" Architectural Grade Window System
Fixed - Projected - Casement



Product Overview

The 1450 Sliding Replica Window provides the aesthetic of a sliding window, but is available in fixed, projected, or casement configurations for better efficiency and durability. Its 4" deep frame and 1/8" wall thickness ensures that the 1450 SR has the strength necessary to securely fit into oversized sliding window openings.

Extruded beveled glazing leg provides a clean appearance and weathertight construction. Style options for the 1450SR include applied muntin grids, built-in shades, multiple trim including scroll trim, and panning for custom looks.

GREEN COMMITMENT

HISTORIC REPLICATION

ENERGY SAVINGS

NOISE CONTROL

BLAST SHIELD

Features & Custom Options

- Azon "Azo-Brader" thermally broken frame and sash, backed by a 10 year warranty against thermal break shrinkage
- Vertical and horizontal stacking members
- Fully mitered overlap sash configuration with fully sealed corners and dual weather-stripping
- Various glazing thicknesses available
- Wide variety of locking and operating hardware available
- Dual and triple glazing with optional integral blinds providing dynamic light control
- Accessory line of receptors, mullions, panning and trim for a customized look
- Optional aluminum extruded screens
- Blast, ballistic and impact glazing available
- Optional aluminum extruded screens

Performance Data*

Type	Air (CFM/FT ² @ 6.24 PSF)	Water (PSF)	Structural (PSF)	CRF	U-Value (Btu/Hr-Ft ² -°F)	STC
Projected AW Grade AP-AW100	Less than 0.10	12 (Higher levels may be available upon request)	+/- 150	60*	0.43*	Contact your local Rep
Casement AW Grade C-AW100	Less than 0.10	12 (Higher levels may be available upon request)	+/- 150	60*	0.43*	

*U-Value, CRF, Water and AW ratings are based on a particular type of glazing and window configuration being used. They are provided for comparison purposes only. They are based on products of standard configuration, tested in accordance with NFRC/FGIA/AAMA specifications, in a laboratory environment under optimum conditions. Performance values will vary according to project specifications, installation, size, configuration, hardware, glass, etc. Any required field testing should be done in accordance with the project specifications and FGIA/AAMA field testing protocol, not this data.



Series 1450 Sliding Replica Detail Drawings

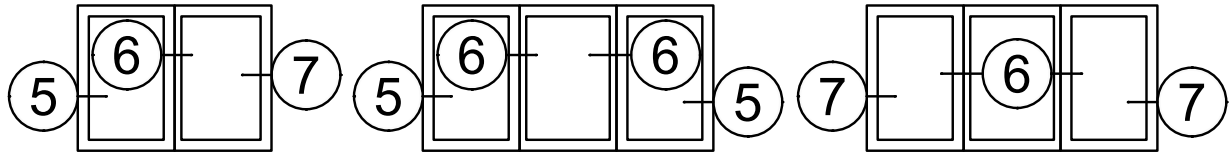

SR-1

SR-4

SR-7

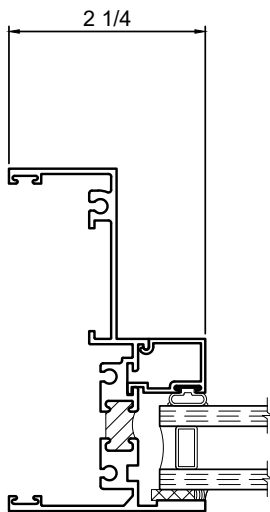

5

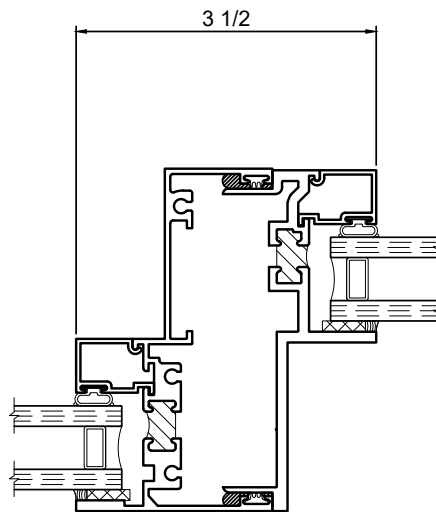

6

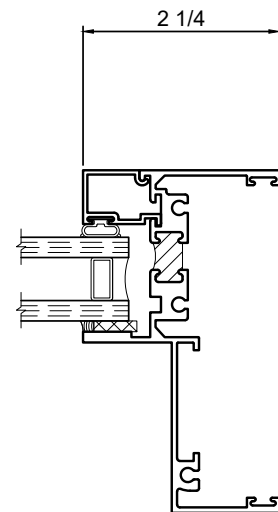

7



Winco Window Company
6200 Maple Avenue
St Louis, MO 63130

TESTING: Our products meet stringent testing requirements of both the American Architectural Manufacturers Association (AAMA) and the National Fenestration Rating Council (NFRC) standards and certification.

VER:131021

