



# Series 1150

2" Architectural Grade Thermal Window System  
Fixed - Projected - Casement



## Product Overview

The 1150 Series window is a versatile platform used with great success in schools, hospitals, offices, and residences for both public and private projects. This window can perform blast, ballistic, impact, and hurricane requirements and can be configured as fixed or in-swing, out-swing projected, and casement. The 1150 Series accommodates challenging openings and configurations.

GREEN COMMITMENT

ENERGY SAVINGS

NOISE CONTROL

BLAST SHIELD

WIND PROTECTION

## Features & Custom Options

- Azon "Azo-Braided" thermally broken frame and sash, backed by a 10 year warranty against thermal break shrinkage
- Vertical and horizontal stacking members
- Fully mitered overlap sash configuration with fully sealed corners and dual weather-stripping
- Various glazing thicknesses available
- Optional aluminum extruded screens
- Dual and triple glazing with optional integral blinds providing dynamic light control
- Wide variety of locking and operating hardware available
- Ability to make inside and outside glazed panels within the same mainframe
- Accessory line of receptors, mullions, panning and trim for a customized look
- Blast, ballistic and impact glazing available

## Performance Data\*

Type	Air (CFM/FT <sup>2</sup> @ 6.24 PSF)	Water (PSF)	Structural (PSF)	CRF	U-Value (Btu/Hr-Ft <sup>2</sup> -°F)	STC
Projected AW Grade AP-AW100	Less than 0.10	12 (Higher levels may be available upon request)	+/- 150	59*	0.39*	Contact your local Rep
Casement AW Grade C-AW80	Less than 0.10	12 (Higher levels may be available upon request)	+/- 120	59*	0.39*	

\*U-Value, CRF, Water and AW ratings are based on a particular type of glazing and window configuration being used. They are provided for comparison purposes only. They are based on products of standard configuration, tested in accordance with NFRC/FGIA/AAMA specifications, in a laboratory environment under optimum conditions. Performance values will vary according to project specifications, installation, size, configuration, hardware, glass, etc. Any required field testing should be done in accordance with the project specifications and FGIA/AAMA field testing protocol, not this data.

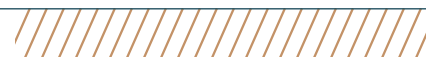

# Series 1150 Detail Drawings

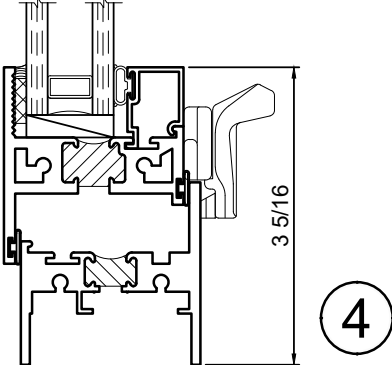
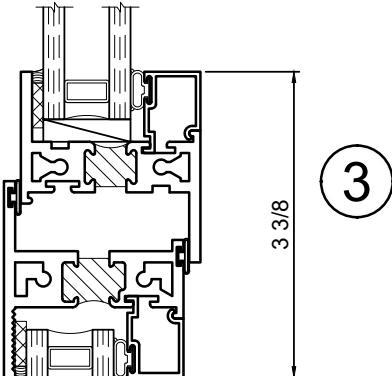
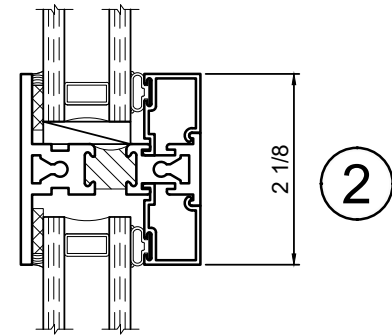
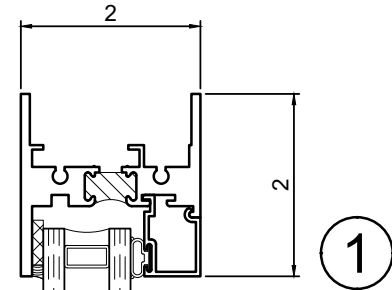
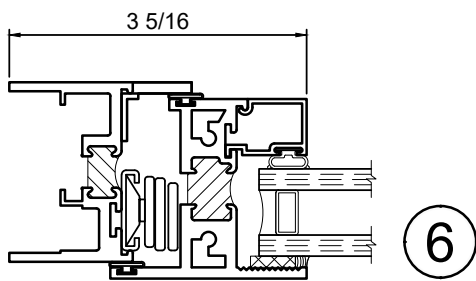
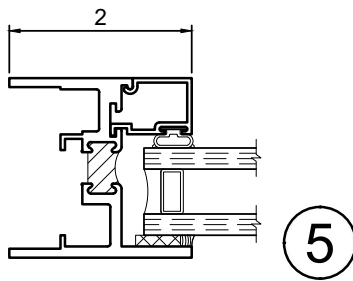
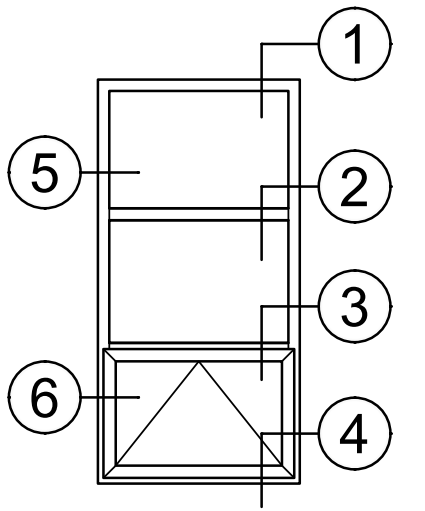

Winco Window Company  
6200 Maple Avenue  
St Louis, MO 63130

TESTING: Our products meet stringent testing requirements of both the American Architectural Manufacturers Association (AAMA) and the National Fenestration Rating Council (NFRC) standards and certification.

VER:110621

